

Setting favorite positions

Once the open and close limits are set, the motor can store two favorite positions. After setting the favorite positions, hold **FAVORITE 1** or **FAVORITE 2** button for 2 seconds to send the motor to the favorite position 1 or 2. If you also use either Neo Smart Blinds app or Neo Smart Blinds Blue app to control your blinds, please read the related topic in the bottom of this page.

Favorite position 1

1. Use **OPEN**, **STOP** and **CLOSE** buttons to go to the desired favorite position 1.

2. Press the **SET + FAVORITE 1** buttons at the same time. The motor will move to confirm that the favorite position 1 was saved.

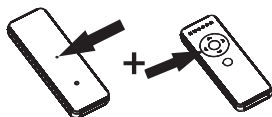

Favorite position 2

1. Use **OPEN**, **STOP** and **CLOSE** buttons to go to the desired favorite position 2.

2. Press the **SET + FAVORITE 2** buttons at the same time. The motor will move to confirm that the favorite position 2 was saved.

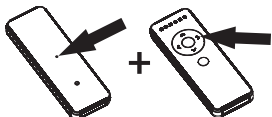

Favorite position in the Neo Smart Blinds and Neo Smart Blinds Blue apps

The favorite position 1 and 2 are accessible to the Smart Controller through the Neo Smart Blinds app. None of the favorite positions set via remote control are accessible to the Neo Smart Blinds Blue app, however you can easily set up a favorite position in the app.

Delete all remote controls

Attention: this procedure does not delete open and close limits or the favorite positions 1 and 2.

1. Hold the **HEAD** button for 3 seconds, until the motor moves.

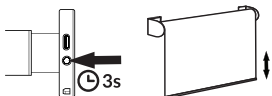

2. Hold the **HEAD** button for 7 seconds, until the motor moves.

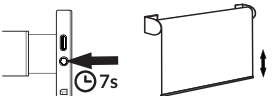

Remote control specification

Transmission power: 10dBm
ASK 433.92MHz wireless transmission
Outdoor transmission distance: 200m
Indoor transmission distance: 35m
Working temperature: -20°C ~ +55°C

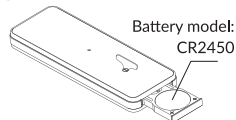

WARNING

- **INGESTION HAZARD:** This product contains a button cell or coin battery.
- **DEATH** or serious injury can occur if ingested.
- A swallowed button cell or coin battery can cause **Internal Chemical Burns** in as little as **2 hours**.
- **KEEP** new and used batteries **OUT OF REACH** of CHILDREN.
- **Seek immediate medical attention** if a battery is suspected to be swallowed or inserted inside any part of the body.



-Remove and immediately recycle or dispose of used batteries according to local regulations and keep away from children. Do NOT dispose of batteries in household trash or incinerate.

-Even used batteries may cause severe injury or death.

-Call a local poison control center for treatment information.

-The compatible battery type: CR2540

-The nominal battery voltage: DC 3V

-Non-rechargeable batteries are not to be recharged.

-Do not force discharge, recharge, disassemble, heat above 55°C or 130°F or incinerate. Doing so may result in injury due to venting, leakage or explosion, resulting in chemical burns.

-Ensure the batteries are installed correctly according to polarity (+ and -).

-Do not mix old and new batteries, different brands or types of batteries, such as alkaline, carbon-zinc, or rechargeable batteries.

-Remove and immediately recycle or dispose of batteries from equipment not used for an extended period of time according to local regulations.

-Always completely secure the battery compartment. If the battery compartment does not close securely, stop using the product, remove the batteries, and keep them away from children.

FCC Caution

This device complies with part 15 of the FCC Rules. Operation is subject to the following two conditions:

(1) This device may not cause harmful interference;

(2) this device must accept any interference received, including interference that may cause undesired operation.

Any Changes or modifications not expressly approved by the party responsible for compliance could void the user's authority to operate the equipment.

Note: This equipment has been tested and found to comply with the limits for a Class B digital device, pursuant to part 15 of the FCC Rules. These limits are designed to provide reasonable protection against harmful interference in a residential installation. This equipment generates uses and can radiate radio frequency energy and, if not installed and used in accordance with the instructions, may cause harmful interference to radio communications. However, there is no guarantee that interference will not occur in a particular installation. If this equipment does cause harmful interference to radio or television reception, which can be determined by turning the equipment off and

on, the user is encouraged to try to correct the interference by one or more of the following measures:

-Reorient or relocate the receiving antenna.

-Increase the separation between the equipment and receiver.

-Connect the equipment into an outlet on a circuit different from that to which the receiver is connected.

-Consult the dealer or an experienced radio/TV technician for help.

The device has been evaluated to meet general RF exposure requirement. The device can be used in portable exposure condition without restriction.

Industry Canada Notice

This device complies with Industry Canada's license-exempt RSSs. Operation is subject to the following two conditions:

(1) This device may not cause interference; and

(2) This device must accept any interference, including interference that may cause undesired operation of the device.

The device has been evaluated to meet general RF exposure requirement. The device can be used in portable exposure condition without restriction.

NEO REMOTE CONTROL

Compatible with all Neo motors,
except TM-WO and TM-WB motors

Version 7.0

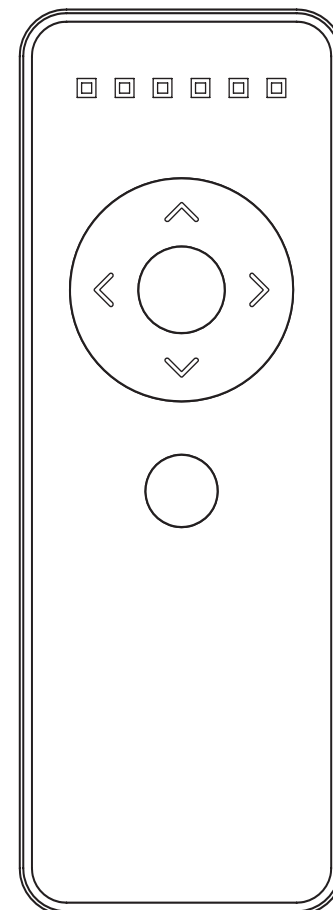

ENGLISH

Models
RC-201
RC-202
RC-206

powered by Neo Smart Blinds

Getting to know your Neo Remote Control

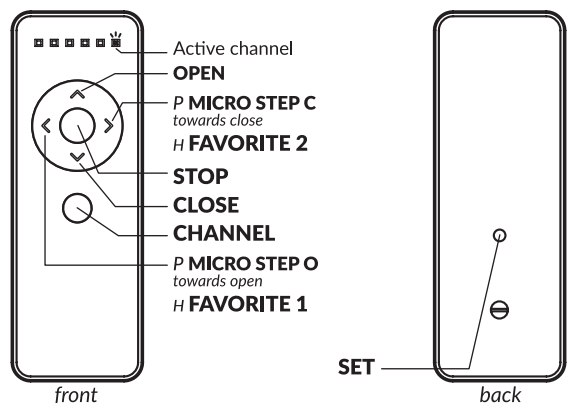

P - Press the button
H - Hold the button for 2 seconds

Basic operation

Unless noted, all commands are sent from a remote control to a motor, and will only have effect if the remote control's active channel has been paired with the desired motor.

Key	Description
Press OPEN	The motor moves all the way to the open limit ¹ .
Press CLOSE	The motor moves all the way to the close limit ¹ .
Press STOP	The motor stops any ongoing motion.
Press MICRO STEP O	The motor moves a small amount towards the open limit.
Press MICRO STEP C	The motor moves a small amount towards the close limit.
Hold FAVORITE 1 for 2 seconds	The motor moves to the favorite position 1.
Hold FAVORITE 2 for 2 seconds	The motor moves to the favorite position 2.
Press CHANNEL	The remote control cycles to the next channel (or group of channels), making it active ² .

1 - The motor will stop on button release if the limit is not yet set.
2 - This command is not sent to the motor, and affects only the remote control on which it is executed.

Choosing a channel

In order for a remote control to execute commands on a motor, its active channel must be paired with that motor. Use the instructions below to choose a channel, then proceed to the pairing process.

1. Press the **CHANNEL** button as many times as needed to select the desired channel to pair the motor.



Pairing process

Set remote control channel using the button on the HEAD

1. Hold the **HEAD** button for 3 seconds, until the motor quickly moves.
2. Press the **SET** button on the back of the remote control, the motor will move to confirm the operation.

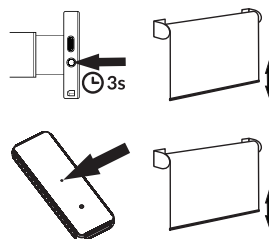

Copy remote control channel

1. Using a previously programmed remote control (A), hold the **SET** button on the back of the remote control for 3 seconds, until the motor quickly moves.
2. Using the new remote control (B), press **SET** button on the back of the remote control, the motor will move to confirm the new remote/channel was paired.

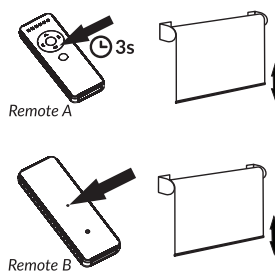

Reverse direction

1. Hold the **SET** button on the back of the remote control for 3 seconds. The motor will quickly move to indicate the process has started.
2. Press the **CHANNEL + STOP** buttons at the same time, the motor will move to confirm the operation.

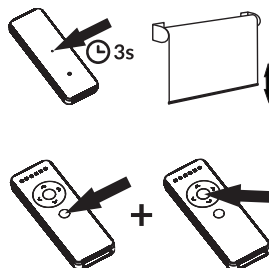

Setting limits

If the motor comes with no limits set from the factory, the open and close commands will be the same as micro step o and micro step c.

Open limit

1. Hold the **SET + OPEN** buttons at the same time for 3 seconds. The motor will move to indicate the process to set up the open limit has started.

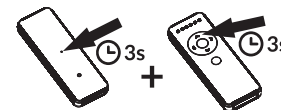

2. Use **OPEN** and **CLOSE** buttons to go to the desired open position.

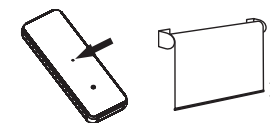

3. Press **SET** button on the back of the remote control, the motor will move to confirm that the new open limit position has been saved.

Close limit

1. Hold the **SET + CLOSE** buttons at the same time for 3 seconds. The motor will quickly move to indicate the process to set up the close limit has started.

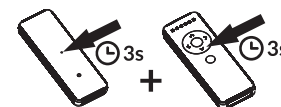

2. Use **OPEN** and **CLOSE** buttons to go to the desired close position.

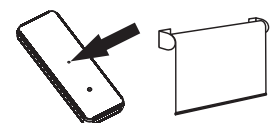

3. Press **SET** button on the back of the remote control, the motor will move to confirm that the new close limit position has been saved.

Delete limits

1. Hold the **SET + STOP** buttons at the same for 3 seconds. The motor will move to indicate the limits have been deleted.

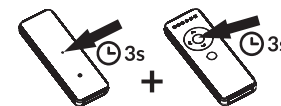

Don't forget to always select the correct channel of the motor you want to adjust.